

FARR 40 CLASS ASSOCIATION



The following amendments to the Class Rules have been approved to be effective 1st January 2007. *All text in red indicates new or changed wording.*

Modification to Permit Masthead Spinnakers for Class Racing

Add New Drawing:

DRAWING # 27 – MASTHEAD SPINNAKER HALYARD SPECTACLE PLACEMENT”

Add New Drawing:

DRAWING # 28 – OPTIONAL SPINNAKER POLE INBOARD QUICK DISCONNECT FITTING”

10.3 (i) FOREGUY - *Add sentence at end of paragraph, “Ratchet blocks with a becket and snap shackle, minimum breaking strength of 1135 kg, may be used for the deck block”.*

19.9 *Remove final sentence: “The masthead halyard shall not be used for Farr 40 One Design class events”.*

22.0 SPINNAKER POLE

22.1 LENGTH - The length of the spinnaker pole on the mast when set in a horizontal position athwartships measured from the centerline of the spinnaker pole track to the extreme outboard end of the pole and any fittings used when a spinnaker is set shall not be greater than 5200 mm.

22.2 WEIGHT - The spinnaker pole complete with all attached fittings shall weigh not less than 7.3 kg or more than 8.8 kg including bridles and end fittings.

22.3. PLACEMENT – When not in use while racing, the spinnaker pole shall be stored connected to the mast or on the foredeck if disconnected.

25.1 NUMBER OF SAILS ABOARD - The sail inventory shall be declared prior to the start of each One Design class regatta (see Appendix 5) and shall not exceed the following number and type:

- 1 mainsail
- 3 jibs
- 1 masthead spinnaker (constructed from cloth of no less than 30 grams/meter²)
- 1 masthead spinnaker (constructed from cloth of no less than 40 grams/meter²)

FARR 40 CLASS ASSOCIATION



- 2 fractional spinnakers (one fractional shall be required on board at all times)
- 1 Farr 40 heavy weather jib (Conforming to current ISAF Special Regulations)
- 1 ISAF storm trysail (or a working reef in the main in accordance with ISAF Special Regulations 4.26).
- 1 jib top sail (to be used in designated Farr 40 distance races only)

25.6 **BUTTONS/SAIL LIMITATIONS** - All sails declared for a Farr 40 Class event may be inspected by a Class measurer and shall have a numbered Class button sewn on near the tack of the sail. Buttons shall not be transferred from one sail to another. Owners with more than one boat may not transfer sail inventories. Owners who charter are permitted to transfer their own sails to the chartered boat. Sail buttons can be purchased from Stagg Yachts or a regional class administrator for US \$60.00 each and may be available at sail check-in. In addition to the base inventory outlined in Rule 25.1, each owner is permitted seven new class sails, plus one additional masthead spinnaker button in 2007 and one additional button for a jib top, per calendar year (January 1 - December 31). Sails must be ordered and construction completed by the end of the calendar year. Buttons not purchased will not accrue into the following year. Charterers who do not own a Farr 40 may purchase an original inventory, plus seven new buttons per year, and transfer sails to different chartered boats.

28.2 **WEIGHT** – Spinnakers shall be constructed from cloth weighing no less than 30 grams/meter². If an owner chooses to declare two masthead spinnakers for a regatta, one masthead spinnaker shall be constructed from cloth weighing no less than 40 grams/meter². If only one masthead spinnaker is carried on board, it can be either weight.

Replace existing rule with 32.3 with: **RUNNING RIGGING** – The minimum diameters of the halyards are defined in Appendix 6 this also states the recommended minimum breaking strengths and materials.

Appendix 6: *Add line to spreadsheet after Main Halyard –*

Description: Masthead Spinnaker Halyard

Min Breaking Strength: 1675 kg

Qty: 1

Min Rope Size/Type (standard pkg): 3/8" or 9mm Technora

Terminal: Tylaska T8

Length: 143'

Comments: Cover may be stripped for 50'

FARR 40 CLASS ASSOCIATION



Appendix 6: Delete word, “*optional*” after POLE TOPPING LIFT in description. column.

Appendix 6: modify the layout of the table to clearly define whether the lengths specified are maximums or minimums by placing the specified lengths into a maximum or minimum column.

Replace: Drawing 24B with revised Drawing 24B

MAST COMPLIANCE CERTIFICATE

Item 6, Rule 22.2 minimum 7.3 kg maximum 8.8 kg

FARR 40 BUILDER COMPLIANCE CERTIFICATE

Item 33, Rule 22.2 minimum 7.3 kg maximum 8.8 kg

DRAWING # 28

OPTIONAL SPINNAKER POLE INBOARD
END QUICK DISCONNECT FITTING

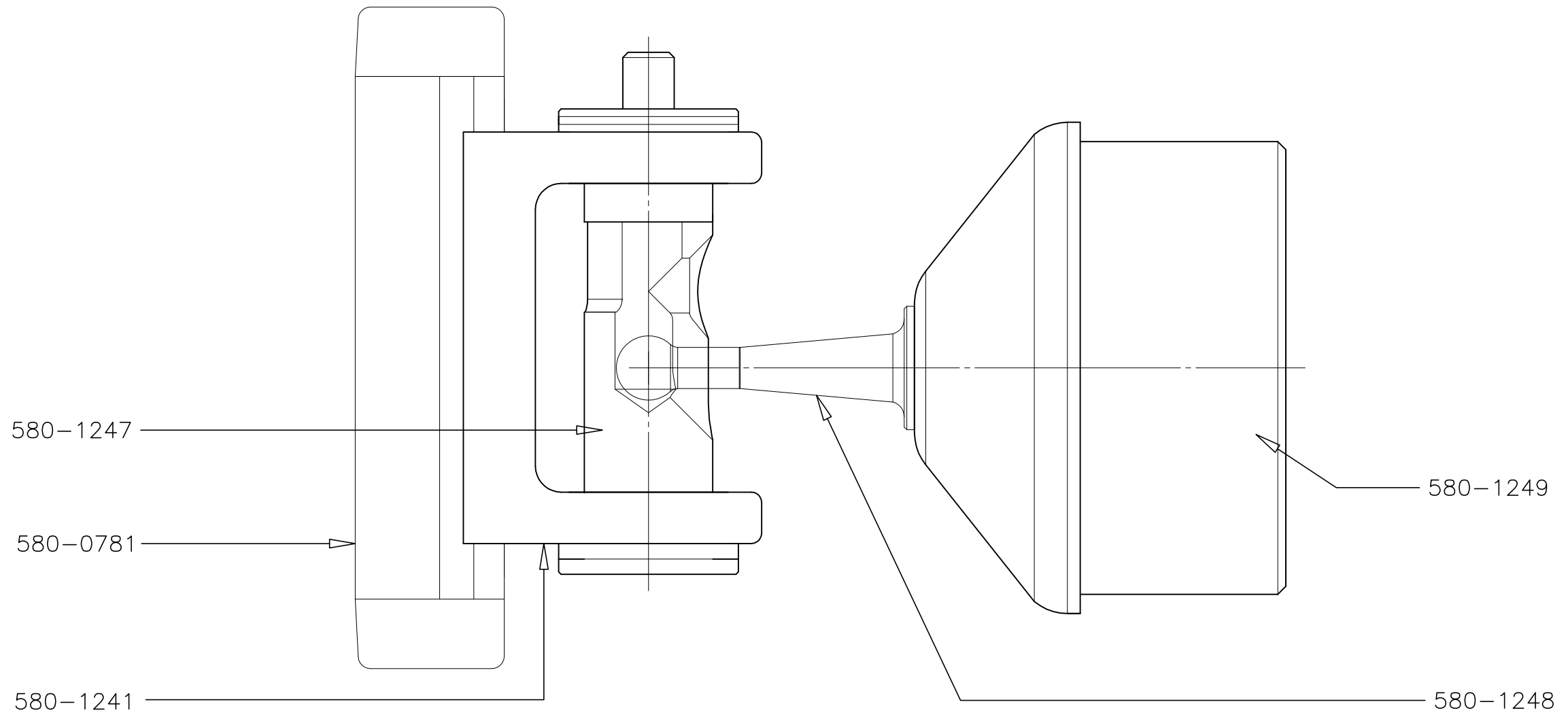

QUICK RELEASE CAR ASSEMBLY
PART# 580-1000*

SPINNAKER POLE IBE ASSEMBLY
PART# 580-1001*

* PARTS MANUFACTURED BY SOUTHERN SPARS

REVISION DETAILS		DRAWN	CHECKED
# 1	DATE_1	DWN_1	CHK_1
	DETAILS_1		CHK_2



TITLE				OPTIONAL SPI POLE IBE FITTING			
SUB TITLE				SOUTHERN SPARS FARR 40 ONE DESIGN			
PROJECT CO-ORDINATOR	DRAWN	SECTION	SCALE	SIZE			
JNW	JNW		1:1	A3			
JOB No.	DATE						
JOB	16/10/2006						

THIS DRAWING IS THE PROPERTY OF SOUTHERN SPARS. IT IS TO BE USED ONLY FOR THE PROJECT AND DATE SPECIFIED. ANY REUSE OR MODIFICATION WITHOUT THE WRITTEN PERMISSION OF SOUTHERN SPARS IS STRICTLY PROHIBITED.